

R6 SKG



PRODUCT

The R6 SKG cylinder with freely duplicating keys is an entry-level reversible key system with high drilling-resistance. The R6 SKG is available in key different and key alike versions.

APPLICATION

R6 SKG is suitable for securing the entrances of your home or of a commercial facility.

VERSION

Available in compact and modular design as:

- single profile cylinder
- double profile cylinder
- pre-arranged for knob
- knob cylinder

Available in compact design as:

- rim cylinder
- round cylinder

TECHNICAL PRODUCT FEATURES

- Cylinder body and plug made of brass in the standard version matt nickel-plated
- Suitable for installation in fire doors
- Encryption pins in stainless steel
- Counterpins in brass
- Springs in stainless steel
- Euro-profile cylinder (norm)
- Locking cam made of sintered steel
- Locking cam in min. 30° position (according to DIN)
- In each plug are 2 picking-resistant counterpins
- The drilling protection consists of hardened steel pin in the cylinder body and plug
- Hardened steel strengthening bar for increased snap and cylinder extraction resistance

SINGLE PROFILE CYLINDER

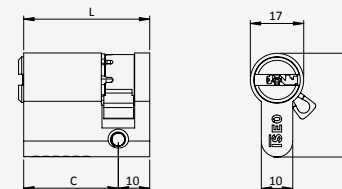

EUROPEAN DOUBLE PROFILE CYLINDER

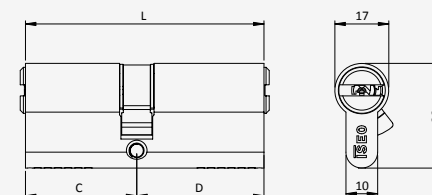

EUROPEAN DOUBLE PROFILE CYLINDER. ROUND KNOB

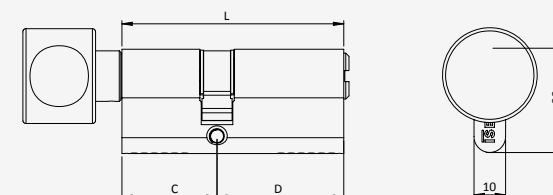

R6 SKG

FEATURES

R6 SKG has 6 encryption pins from a length of 30-30 made of wear-resistant special brass, per locking side.

A drilling protection as well as anti-pick protection is integrated in the profile cylinder.

The surface of the cylinder body is matt nickel-plated or brass as standard.

The keys are made of nickel coated brass.

Optionally selectable features:

- emergency and danger function

Further systems of the R6 series:

- R6 standard
- R6 SPI (with patented SPI pin)
- R6 Plus (construction key)
- R6 MC (with magnet)

More details can be found on the respective data sheets

COMPATIBLE WITH

Ergonomic plastic caps in different colours:

- Blue
- Red
- Green
- Grey

STANDARDS

Compact version:

DIN EN 1303: 2015-08

1|6|0|B|0|C|5|D

SKG**

EN1627 RC3

IMP C

Modular version:

DIN EN 1303: 2015-08

1|6|0|B|0|C|5|D

SKG**

PRE-ARRANGED FOR KNOB

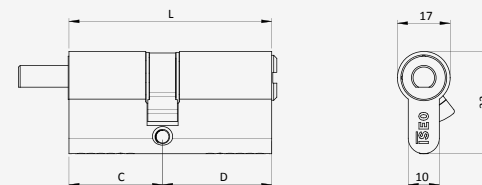

EXTERNAL RIM CYLINDER

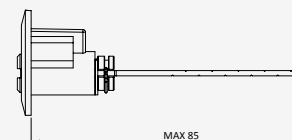

ROUND CYLINDER

