

# R9 Plus



## PRODUCT

The CSR R9 Plus cylinder is a reversible locking system which is part of the CSR product family. The R9 Plus cylinder is available in different locking, keyed alike versions and masterkey systems.

## APPLICATION

A cylinder combining key protection with independent cylinder profiles to restrict the use of each profile to specific geographic zones.

With three rows for encryption, this cylinder is suitable for medium sized master key systems.

## VERSION

**Available in compact and modular design as:**

- single profile cylinder
- double profile cylinder
- pre-arranged for knob
- knob cylinder

**Available in compact design as:**

- scandinavian type
- rim cylinder
- round cylinder
- lever round cylinder
- microswitch

## TECHNICAL FEATURES

- Cylinder body and plug made of brass in the standard version matt nickel-plated
- Suitable for installation in fire doors
- Encryption pins in stainless steel
- Counterpins in brass
- Springs in stainless steel
- Euro-profile cylinder (norm)
- Locking cam made of sintered steel
- Locking cam in min. 30° position (according to DIN)
- In each plug are 2 picking-resistant counterpins
- The drilling protection consists of hardened steel pin in the cylinder body and plug
- Each cylinder core contains 2 profile pins which interrogate the key lance
- The drilling protection consists of a hardened steel pin in the cylinder body
- Hardened Steel Strengthening Bar for increased snap and cylinder extraction resistance

# R9 Plus

## HIGHLIGHTS

- R9 Plus has 6 encryption pins in the inferior line, up to 4 pins in the lateral line and 2 pins in the superior line from a length of 30-30 made of wear-resistant special brass, per locking side
- A drilling protection as well as anti-pick protection is integrated in the profile cylinder
- The surface of the cylinder body is matt nickel-plated or brass as standard
- The keys are made of nickel silver

## Optionally selectable features:

- emergency and danger function
- free cam
- construction key

## STANDARDS

Compact and modular version:  
DIN EN 1303: 2015-08  
1|6|0|B|0|C|5|D  
SKG\*\*  
BSI\*

# R9 Plus

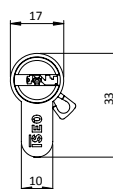
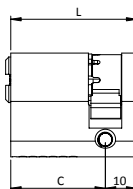

Single profile cylinder

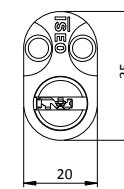
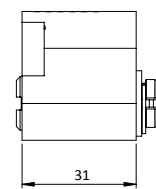
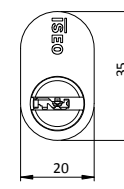
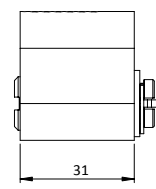

Oval scandinavian cylinder

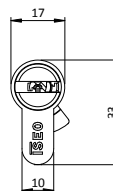
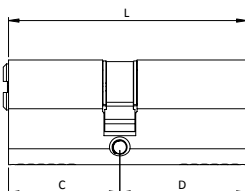

European double profile cylinder

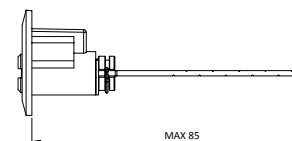

External rim cylinder

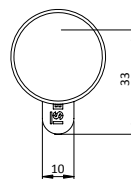
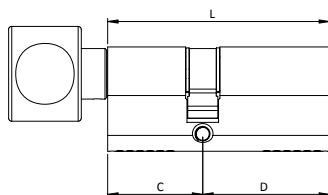

European double profile cylinder. Round knob

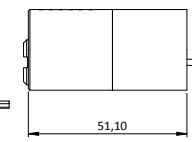
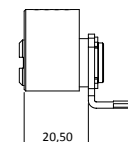

Round cylinder