

# Trim Tronic

External electronic control



## PRODUCT

External electronic control with a protection rating of IPX5 against water jets

## APPLICATION

Available in two versions:

- it can be combined with all ISEO rim panic devices with 1, 2, 3 locking points;
- it can be combined with ISEO mortice panic devices and mechanical locks of the series 214\*, DINFIR3 panic locks:
  - the Trim Tronic is used to enable or disable the external handle
  - the Trim Tronic only works correctly if the lock has not been locked from the inside (deadbolt out or square handle disabled) except DINFIR3 function E
  - it is not possible to safely close the lock from the outside using the Trim Tronic
  - for use on fire-rated doors, a single profile cylinder must be used, or a suitable protection of the cylinder hole in the lock

It's an innovative solution that allows access control from the outside, while maintaining the panic function from the inside.

Trim Tronic can interface with an access control device while still ensuring the panic function on emergency exits.

Thanks to its IPX5 degree of protection, the device is also suitable for outdoor applications.

## TECHNICAL FEATURES

- Case in zamak
- Free moving handle when disabled
- Power supply: 12 Vdc, maximum current absorption 2A
- 5 m power cable supplied
- Handle and key status signal (enabled/disabled)
- Input for enabling/disabling button
- R6 40 mm (30-10) European monoprofile cylinder
- 8 mm square handle
- Operating temperature: -10°C - +60°C in according to EN 1125:2008
- Colours available: black, white, metal grey, ENDUR4NCE
- Anti-bacterial protection: AntiGerm
- IP class: IPX5
- Suitable for fire-rated doors



# Trim Tronic

External electronic  
control

## OPERATION

- Reversible hand: installation on doors with either right-hand or left-hand opening
- Temporary enabling of the handle with electrical remote control (button 1):
  - an impulse lasting less than 6 seconds enables the handle for 6 seconds
  - an impulse lasting more than 6 seconds enables the handle for the entire time of the impulse
- The handle can also be enabled using the mechanical key: insert, rotate and remove the key
- During the installation phase, a “non removable” key function can be configured
- An electric command (button 2) allows the use of the mechanical key to be blocked until an electric opening operation has been performed (with button 1)
- The Trim-Tronic status conditions are indicated as follows:
  - fixed red LED = handle not enabled
  - flashing green LED = handle temporarily enabled
  - fixed green LED = handle opened with mechanical key
- The connection cable (code 94403030E) supplied is used to transfer the light signals, opening and key block commands, and power supply to a remote control unit

## HIGHLIGHTS

- Designed to be compatible with both ISEO rim and mortice panic and emergency devices
- Designed to comply with Standards EN 1125 and EN 179
- Can be installed on both single and double leaf doors
- When used with rim devices, it replaces all ISEO external mechanical commands
- External handle equipped with vandal protection system
- Can be installed on any type of frame (aluminium, PVC, wood, etc.)
- 12V DC-2A power supply
- Suitable for installation in outdoor environments

# Trim Tronic

External electronic control

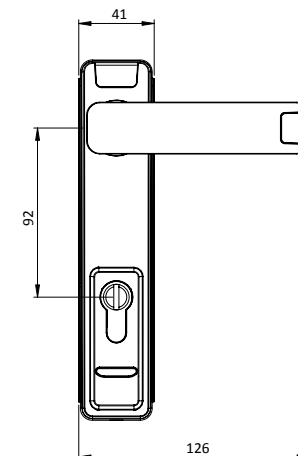
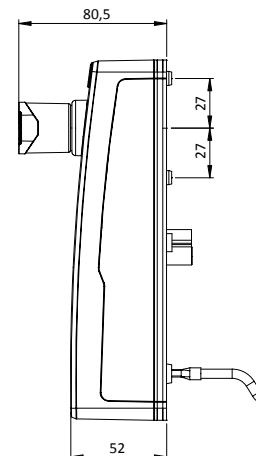
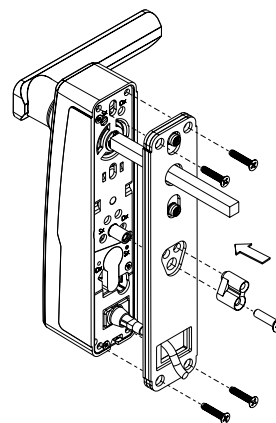
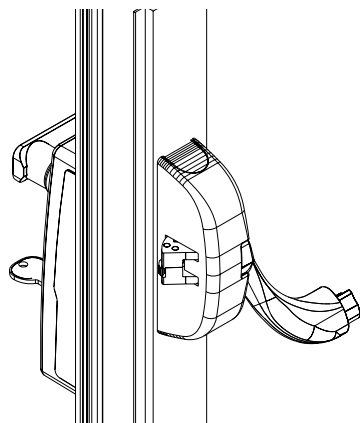

Trim Tronic rim type

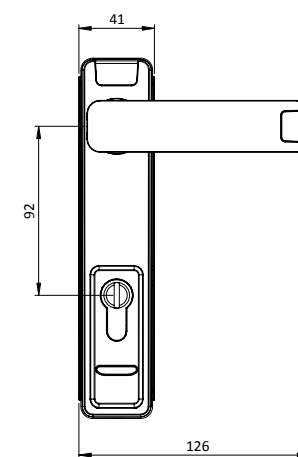
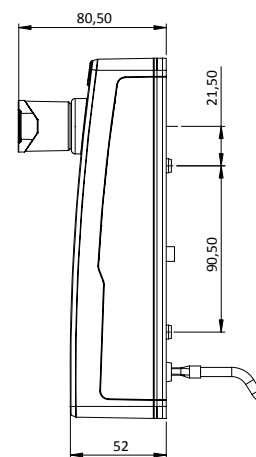
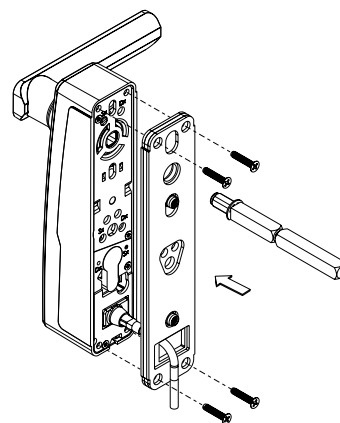
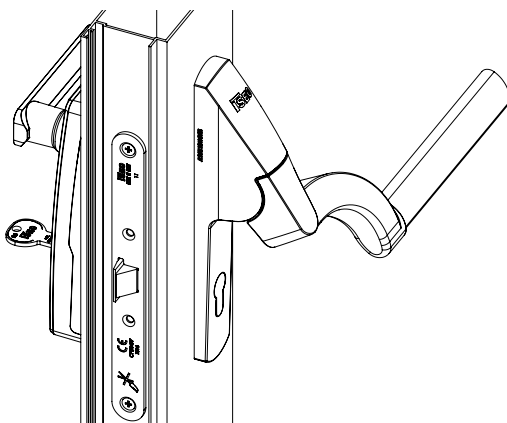

Trim Tronic mortice type