

Locks with
Deadlocking Latchbolt
Locks with
Free moving Handle

FOR ARMOURED DOORS



ISEO[®]
ULTIMATE ACCESS TECHNOLOGIES

Locks with **Deadlocking Latchbolt**

Locks with **Free moving Handle**

LOCKS FOR ARMoured DOORS

Lock with Deadlocking Latchbolt

It maximises the security of the door and for this reason its application is recommended, for example, in the main entrance of a residential building. In this scenario, the door is normally closed by the door closer, without engaging the deadbolts, meaning that the security of the building depends solely on the efficacy of the latch. The lock can be combined with a specific electric strike, so that it is possible to open it with the individual internal intercoms of the building.



Lock with free moving handle function

It increases the performance of the door, as when locked with the deadbolt, any unintentional opening of the latch is disabled. In this way the door remains correctly aligned with the frame, ensuring uncompromised thermal acoustic insulation and a limited wear of the door.





European
standard
EN12209

Locks with Deadlocking Latchbolt

Electric strikes

Centre distance
28-37/38 mm
with RH/LH configuration



**Version with reversible latch
and charge piston at the bottom**
Centre distance 28 and 37 mm
Latch projection 3,5 or 13,5 mm

**Version with reversible latch
and charge piston at the top**
Centre distance 28 and 38 mm
Latch projection 3,5 or 13,5 mm



**When the door is closed,
the charge piston remains
compressed, keeping the
latch in the locked position.**

The **deadlocking latchbolt** is equipped with two locking systems: one of these is activated when the latch is fully extended, while the other comes into play when the latch is at approximately mid-travel. This dual solution permits its use in combination with an electric strikes and also allows for door installations with additional plastic components used to cover the latch hole for aesthetic reasons. This locking system prevents unauthorized access achieved by pushing against the latch with a credit card or any other tools.

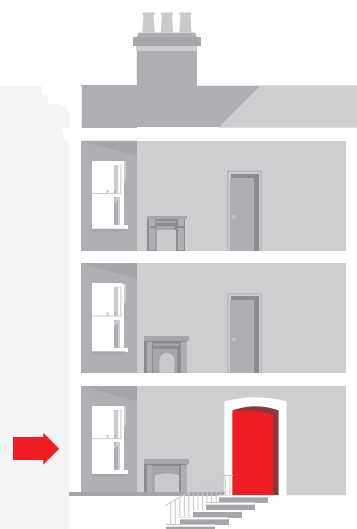



European
standard
EN12209

Locks with Free moving Handle

Version with reversible latch at the bottom

Centre distance 28 and 37 mm
Latch projection 3,5 or 13,5 mm



Version with reversible latch at the top

Centre distance 28 and 38 mm
Latch projection 3,5 or 13,5 mm



The Free moving Handle function is activated
after the first throw of the deadbolt (in the
case of gear locks, the deadbolt has 2 throws).



When the door is locked with the deadbolt extended, the **handle becomes "free moving"** and cannot accidentally retract the latch. This keeps the door correctly aligned in its frame, with benefits in terms of improved thermal and sound insulation and reduced wear over time.

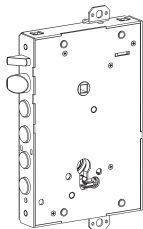
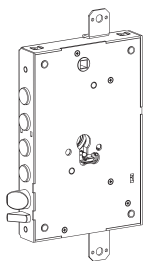

| Descriptions of locks with anti-pick latch | Latch projection | Centre distance | Pack | Prod. Codes |
|--|------------------|-----------------|------|---------------|
| Serie 664G Latch and deadbolt, rim , E.63 | 3,5 | 28 | 1 | 0066403280G00 |
| | 13,5 | | | 0066413280G00 |
| | 3,5 | 37 | | 0066403370G00 |
| | 13,5 | | | 0066413370G00 |
| | 3,5 | 28 | 5 | 0066403280G04 |
| | 13,5 | | | 0066413280G04 |
| | 3,5 | 37 | | 0066403370G04 |
| | 13,5 | | | 0066413370G04 |
| Serie 674G Latch and deadbolt, mortise with faceplate , E.63 | 0,5 | 28 | 1 | 0067400280G00 |
| Serie 664G Latch and deadbolt, rim , E.73 | 3,5 | 28 | 1 | 0066403280G70 |
| | | 37 | | 0066403370G70 |
| | | 28 | 5 | 0066403280G74 |
| | | 37 | | 0066403370G74 |
| Serie 664GF Latch and deadbolt, rim , E.63 | 3,5 | 28 | 1 | 0066403280GF0 |
| | 13,5 | | | 0066413280GF0 |
| | 3,5 | 38 | | 0066403380GF0 |
| | 13,5 | | | 0066413380GF0 |
| | 3,5 | 28 | 5 | 0066403280GF4 |
| | 13,5 | | | 0066413280GF4 |
| | 3,5 | 38 | | 0066403380GF4 |
| | 13,5 | | | 0066413380GF4 |
| Serie 674GF Latch and deadbolt, mortise with faceplate , E.63 | 0,5 | 28 | 1 | 0067400280GF0 |
| Serie 664GF Latch and deadbolt, mortise with faceplate , E.63 with cylinder fastened from front of lock | 3,5 | 28 | 1 | 0066403280GB0 |
| | 13,5 | | | 0066413280GB0 |
| | 3,5 | | 5 | 0066403280GB4 |

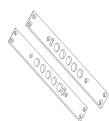

| Accessories for locks with deadlocking latchbolt | Latch projection | Centre distance | Pack | Prod. Codes |
|---|------------------|-----------------|------|---------------|
| Chrome plated steel faceplate for 664G with deadlocking latchbolt | - | 28 | 5 | 10400674G0200 |
| | - | 37 | | 10400674G0300 |
| Chrome plated steel faceplate for 664GF locks with deadlocking latchbolt | - | 28 | | 10400674GF200 |
| | - | 38 | | 10400674GF300 |
| Chrome plated steel faceplate for 664GF with deadlocking latchbolt, and cylinder fastener screw hole | - | 28 | | 10400674GB200 |
| Electric strike per 664G with deadlocking latchbolt | RH | 28 | 1 | 20028E60412V1 |
| | LH | | | 20028E60412V2 |
| | RH | 37 | | 20037E60412V1 |
| | LH | | | 20037E60412V2 |
| Electric strike per 664GF with deadlocking latchbolt | RH | 28 | 1 | 20028E60412V2 |
| | LH | | | 20028E60412V1 |
| | RH | 38 | | 20037E60412V2 |
| | LH | | | 20037E60412V1 |

| Descriptions of locks with free moving handle | Latch projection | Centre distance | Pack | Prod. Codes |
|---|------------------|-----------------|------|---------------|
| Serie 668G Latch and deadbolt, rim , E.63 | 3,5 | 28 | 1 | 0066803281G00 |
| | 13,5 | | | 0066813281G00 |
| | 3,5 | 37 | | 0066803371G00 |
| | 13,5 | | | 0066813371G00 |
| | 3,5 | 28 | 5 | 0066803281G04 |
| | 13,5 | | | 0066813281G04 |
| | 3,5 | 37 | | 0066803371G04 |
| | 13,5 | | | 0066813371G04 |
| Serie 668G Latch and deadbolt, mortise with faceplate , E.63 | 0,5 | 28 | 1 | 0067800281G00 |
| Serie 668G Latch and deadbolt, rim , E.73 | 3,5 | 28 | 1 | 0066803281G70 |
| | | 37 | | 0066813281G70 |
| | | 28 | 5 | 0066803281G74 |
| | | 37 | | 0066813281G74 |
| Serie 668GF Latch and deadbolt, rim , E.63 | 3,5 | 28 | 1 | 0066803281GF0 |
| | 13,5 | | | 0066813281GF0 |
| | 3,5 | 38 | | 0066803381GF0 |
| | 13,5 | | | 0066813381GF0 |
| | 3,5 | 28 | 5 | 0066803281GF4 |
| | 13,5 | | | 0066813281GF4 |
| | 3,5 | 38 | | 0066803381GF4 |
| | 13,5 | | | 0066813381GF4 |
| Serie 668GF Latch and deadbolt, mortise with faceplate , E.63 | 0,5 | 28 | 1 | 0067800281GF0 |
| Serie 668GF Latch and deadbolt, mortise with faceplate , E.63 with cylinder fastened from front of lock | 3,5 | 28 | 1 | 0066803281GB0 |
| | 13,5 | | 5 | 0066813281GB0 |
| | 3,5 | | | 0066803281GB4 |



* See ISEO general catalogue for strike plates and faceplates.



ISEO[®]
ULTIMATE ACCESS TECHNOLOGIES

Iseo Serrature s.p.a.
Via San Girolamo, 13
25055 Pisogne BS, Italy
Tel. +39 0364 8821
iseo@iseo.com

iseo.com